



# StreamBIM

By Rendra AS  
JDM Technology Group



**EASY - FAST - AT YOUR FINGERTIPS**

[www.streambim.com](http://www.streambim.com)

# StreamBIM

StreamBIM is a data- and model centric BIM collaboration platform made by Rendra AS from Norway. The Norwegian construction industry has been developing BIM use for 20 years, and Rendra - founded in 2012 - is on the cutting edge of BIM in the Nordics.

StreamBIM is cloudbased and streams data directly to PCs, tablets and smartphones. Users can access large BIM models on their handheld devices, on the building site. The easy-to-use interface enables easy, real-time interaction throughout the building process between building owners, architects, engineers, contractors, subcontractors, end users, facility managers and other stakeholders.

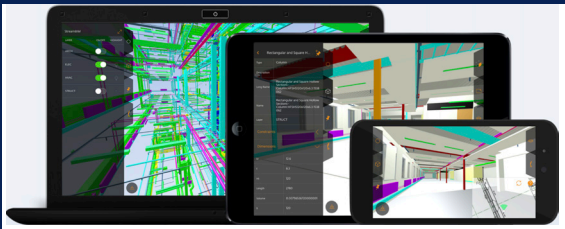

## Key features:

- **3D Viewer** - streaming large BIM and point cloud models on any device.
- **Capture Pro** - issue management and interdisciplinary communication made easy.
- **Checklist Pro** - create checklists for progress management, documentation, quality assurance and health and safety.
- **Document Pro** - import and access various files and PDF documents on any device.
- **Measuring tools** - measure dimensions directly from the model.
- **Query Builder** - create detailed and precise queries for data retrieval and structure to make your work easier.
- **3rd party integration** - as an open data platform, StreamBIM allows for integration with other databases, allowing you to access and integrate your own data.

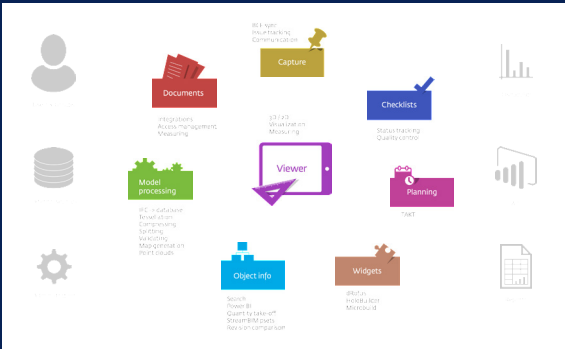

## The StreamBIM ecosystem

**Note:** StreamBIM can also be used without IFC models for pure 2D projects

# ”Bridge the gap”

Use StreamBIM to bridge the gap between design and production and bring seamless collaboration to your projects.



- BIM data and drawings are always updated to the latest version
- Easy and intuitive interface
- Minimise the need for drawings.
- Extract dimensions and the supply chain information required for construction.
- Real-time collaborative workflow.
- Connect design and construction site teams.
- Bring the entire project team together around the BIM model.
- Participate and collaborate from anywhere.

# StreamBIM in Asia

Japan is fast becoming a central market for StreamBIM, but we are also actively developing our business operations in the rest of Asia.

We now have projects being run in StreamBIM in Cambodia, China and Singapore, with projects in more countries under development.

The StreamBIM interface is currently available in several languages used in Asia, like English, Spanish, Japanese and Chinese. We will make more available by customer request.

Our Asia-Pacific operations are currently being run from our new Tokyo office, with data stored on our server with AWS Japan. As new markets develop, we will expand our representation to other countries.

## State-of-the-art security

We have a strong focus on keeping your data secure, and are currently in the process of obtaining ISO 27001 certification in both Europe and Japan.

We have on-premise and flexible server deployment solutions for high-security projects, as well as IP whitelist support.

**The new government office quarter in Oslo, Norway - Run in *StreamBIM on-prem***



# Our users

StreamBIM is used by construction industry stakeholders from start to finish, from design through construction to facility management.

## GENERAL CONTRACTORS



## BUILDING OWNERS



## CONSTRUCTION MANAGEMENT



## SUBCONTRACTORS



## ARCHITECTURAL DESIGN AND ENGINEERING



# Implementation

StreamBIM is easy to implement for companies of all sizes - from small subcontractors to large international corporations. We supply training sessions and materials for builders/craftspeople and company administrators, either by our own staff or in cooperation with local partners.

In our experience, a half-day training course for ordinary users and one-day course for project managers and administrators is enough to get you up and running in StreamBIM.

We can also help your company develop your BIM use by introducing Scandinavian know-how and best practice.

## Takenaka Corporation

Takenaka Corporation is our largest user and partner in Japan. We can testify that Takenaka is on the forefront of BIM and DX in Japan, and it is a great honour to be chosen to be at the heart of their work on creating a company-wide CDE.

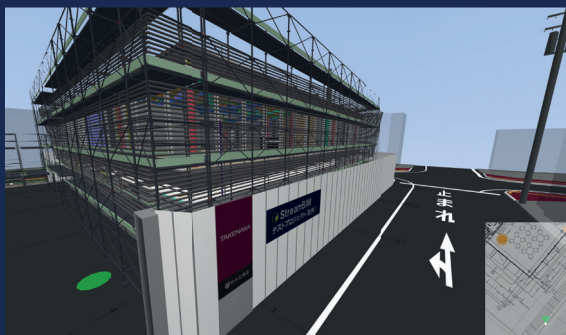

As of December 2022, StreamBIM had been used in 215 Takenaka Corporation projects totalling approx. 5.5 million square metres across Japan and other Asian countries.

# CAPTURE PRO

## On-site BIM issue management

Easily record and communicate on all on-site issues, like deviances, incidents or need for any clarifications. Use smartphones, tablets and PC/BIM stations to document and discuss with other parties on the construction site and in the design office without delay.



Take photos with your mobile or tablet and attach them directly to an issue. All communication will be logged and timestamped. Data registered in StreamBIM is always available and is easily exported to Excel, PDF or BCF reports, or downloaded to a PowerBI dashboard.



You can create your own views containing the geometry, models and information you need and save them in Capture topics and share the views with people who need this information.

This is very useful for creating 'work packages', reporting and resolving problems quickly, as well as documenting work you have completed.

# CHECKLISTS PRO

## Document and monitor progress

Enable smart workflows for all projects teams and maintain an overview of your projects with our intuitive checklists.

You can use our checklist wizard to easily create complex checklists that meet your company's quality standards, then re-use them as templates in future projects.

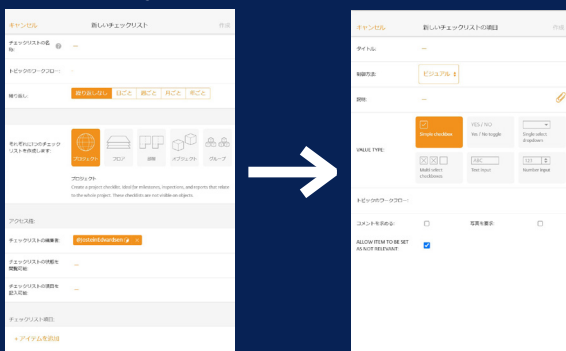

With just a few clicks, checklists are added to model spaces, systems, type objects, floors and property values. The 3D coordinates (X, Y, Z) added to the checklist can be used to get an in-model colour coded view of where inspections have or have not yet been carried out and whether there are any deviations. As long as a deviation is recorded in the checklist, the status of approval is not given until the problem is resolved.

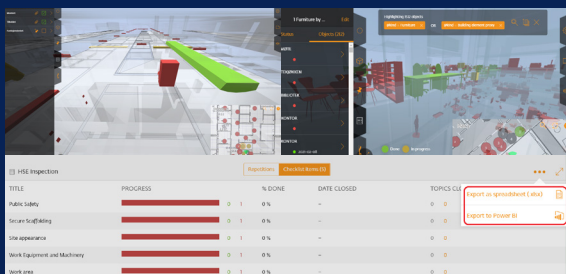

As always, you can generate PDF reports when required, and export the data to Power BI dashboards



# DOCUMENTS PRO

## Saving documents and files

Access documents and drawings on any device. Using labels allows you to quickly find the drawing or document you need with a few clicks, and you can add frequently viewed documents to your favourites for easy access at any time.

Labels can be added to individual files as well as to folders, so that drawings uploaded to them are automatically labelled.

Any PDF or image can be added directly to the capture or checklist, e.g. installation instructions for use on the production floor can be added to the capture.



- Access rights can be set for any file or folder
- Use the measuring tool to measure directly on PDF drawings.
- Access previous revisions drawings.
- Revert deleted items.
- Back up archives at the end of a project.
- Synchronise with external document storage providers (if required).

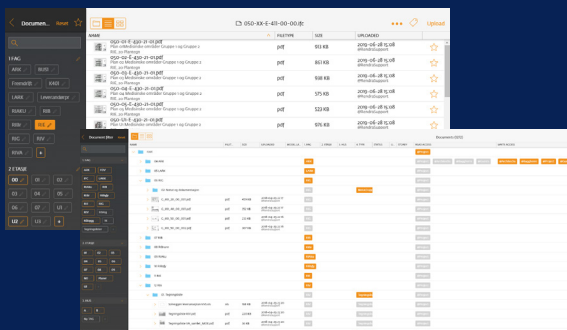

# Measuring tools

StreamBIM's innovative measurement tool can be used on mobiles and tablets in the same way as on a PC.

- Take measurements on the go and save views with measures you need, either for later use or documentation.
- Share saved, preconfigured views with other team members, reducing the need for paper drawings.
- Create 2D sections for easy measurement.
- End-to-end or multi point measurements.
- Pipe cores, BIM objects and point clouds can be snapped.
- Circular dimensions with pipe attributes are automatically added.
- Snap points for smart pipes.
- See the incline of sloping pipes.

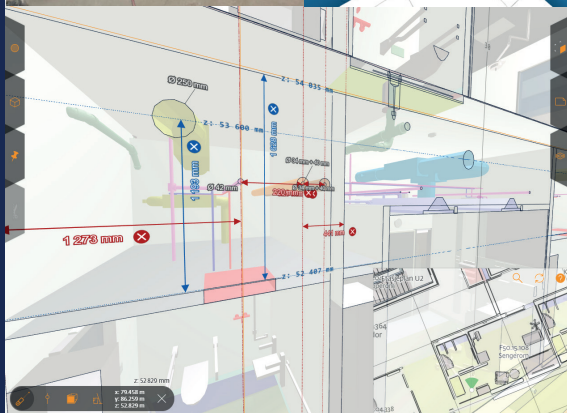

# Query Builder

The Query Builder can be used to search for and refine information, locations and objects relevant to any task.

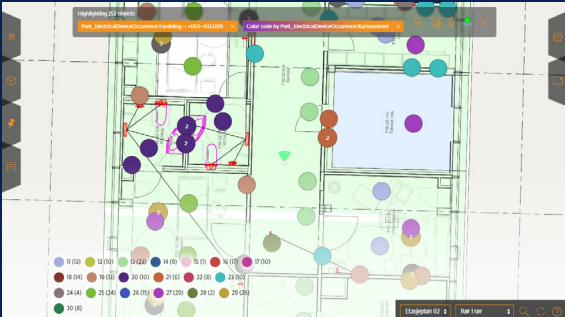

Any work process starts with a subset of the federated model. The key to success is being able to efficiently narrow down the data set each person needs. With just a few clicks, all information in the model is readily available. The search results can be exported, or saved and viewed when needed, on all devices, in both 2D and 3D.



# 3rd party integrations

Information must be easily accessible to the people who need it, when they need it. The StreamBIM platform is based on open standards and we support easy integration with third-party products. This allows customers to manage their own data and efficiently use our platform and other software of their choice through API integration. Customers have the flexibility to change their strategy and choice of software as and when they need it.

The widget solution allows third-party software to be integrated directly on the platform and interact with the geometry and information in the IFC model. For example, we currently have widget integrations with dRofus, Holo Builder and MicroBuild. We are always working on integrating with more softwares, and offer customer-specific integrations.

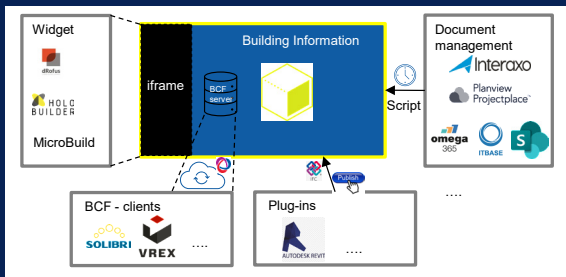

StreamBIM supports the following file formats:

- IFC
- BCF (BIM Collaboration Format, an open format for communication including x,y,z location information)
- E57 & Laz (point cloud format)
- Open API
- FTP (an open API for point cloud communication, including x,y,z location information)

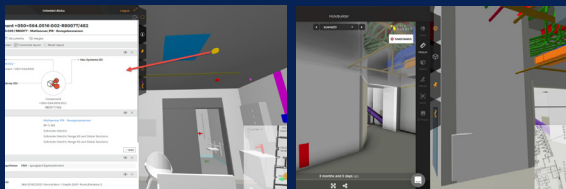

dRofus

Microbuild

# Access your data

Our integrated project dashboard provides an overview of all issues that emerge throughout the project lifecycle. It gives you complete control over which issues are assigned, to whom and from whom they were assigned, when they are due and what their current status is.

See who is responsible, location, category, tags and status. It is also possible to synchronise data from multiple projects to an enterprise dashboard via the API.



Exporting to Microsoft Power BI also allows you to create highly detailed dashboards that give you an overview of the entire project in near real-time.

## IFC History

This exciting new feature lets you see which model objects have been added, changed or deleted in the most recently uploaded IFC files.

Compare revisions and find when design changes occurred. You can then use this information as a basis for documenting claims, etc.

**Please note: The extent of history storage depends on the customer's wishes and needs. Additional charges may apply.**

# Point cloud support

StreamBIM lets you stream large point clouds on any device. Compare designed BIM and actual construction.

Measure geometry within the point cloud or between point cloud and BIM.



Some features:

- Measure deviations between the 3D model and the laser scan
  - Several view modes to compare *as built* point clouds within the overlapping model
  - Highlight the point cloud to make it easier to see the overlapping geometry
  - Layers can be switched on and off
  - Mixed IFC and point cloud topics
  - Design model displayed within the surrounding point cloud
- Supported file formats are **.e57** and **.las**



# Real-time Quantity takeoff

With StreamBIM, it is easy to get an overview of the data from the model and take ownership of important BIM data.

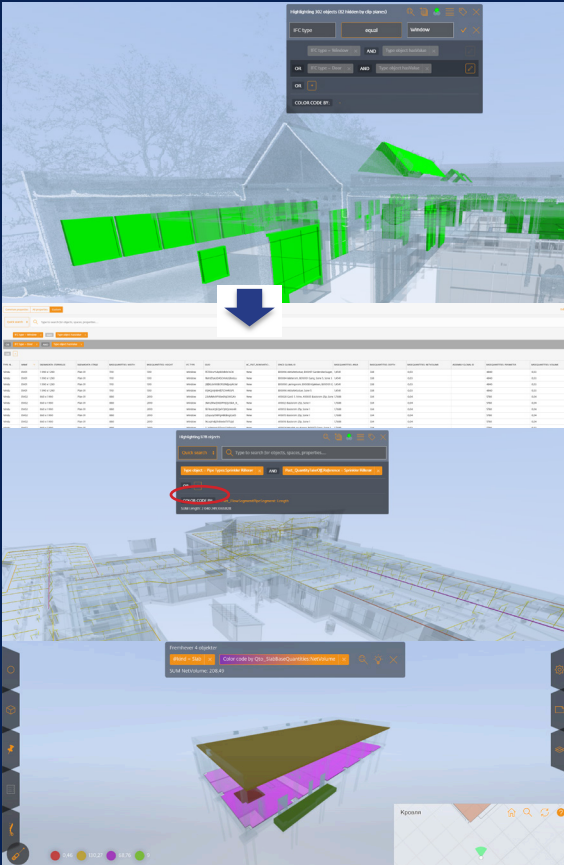

Real-time quantities can be obtained from the model in a few clicks:

- Numeric value
- Length (in system)
- Areas and volumes (aggregated from properties)
- Full flexibility of what data parameters you want to be included in reports
- Easy export to Excel or PowerBI

## 2D-tags

Create your own views with 2D-tags based on the information you need and save them at the capture point. Captures can be shared with those who need them to provide relevant information.

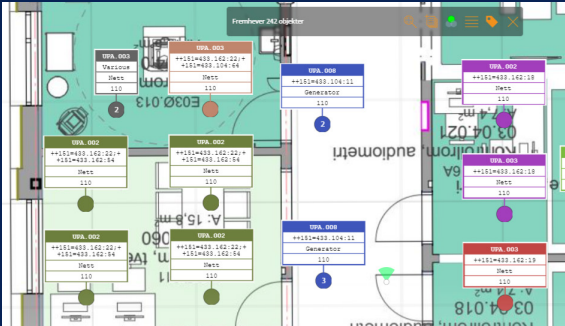

You can include any searchable information contained in the BIM in the tags. The 2D tags can be scaled and rotated to fit the position and size of the screen, maintaining readability.

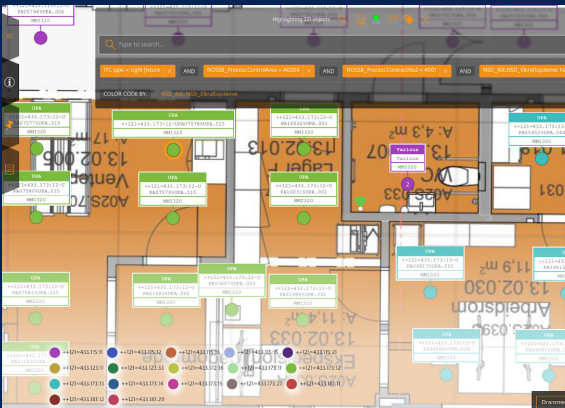
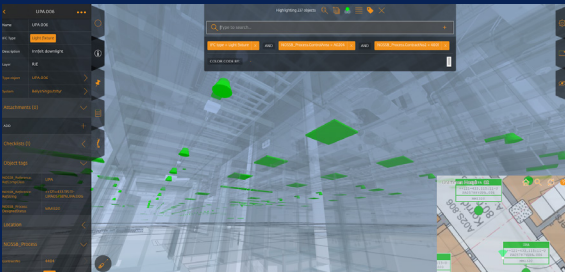



# Building site diary

Created as a digital version of the 'building site diary' which is widely used in the Norwegian construction industry, this daily report module lets users record the status of the construction site on a daily basis.

Record relevant information every day to maintain a record for documentation and referencing. Search past dates to see what problems or weather conditions occurred on that day.

Entries are recorded with a time stamp and the daily report can be exported as a PDF for documentation purposes.

日付	金曜日, 27日 11月 2023		
10月 2023	天気	Overcast clouds 4.91°C (40.44°F, 46.03°F) 10.9 m/s	建設の状況
▼ 10月 19日			
27	大気コメント		
26	労働力		
25	遅延		
24	進行中の作業		
23	予定スケジュール		
22			
21	他の		
20	ワークフロー管理	オープン	閉じる
19	09_設計変更指示の09_報告	0 (0)	0 (0)
18	09_設計変更指示の09_報告	0 (0)	0 (0)
17	09_設計変更指示の09_報告	0 (0)	0 (0)
16	09_設計変更指示の09_報告	57 (0)	7 (0)
15	09_設計変更指示の09_報告	74 (0)	12 (0)
14	09_設計変更指示の09_報告	25 (0)	3 (0)
13	09_設計変更指示の09_報告	0 (0)	0 (0)

The daily reports details progress and status on specific dates.

See daily statuses on:

- Workflows
- Checklists
- Weather conditions

See what notes have been made about:

- The workforce
- Work in progress
- Delays
- Accidents
- Other incidents, etc.

## QR Codes

Generate QR codes for quick indoor location or product labelling, ordering, etc.

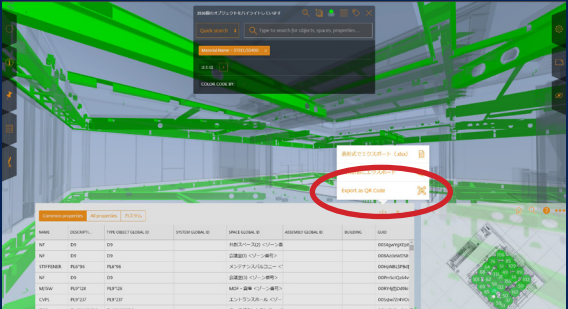

StreamBIM can easily generate QR codes and add any object information to the label.

The codes can be used for:

- Easy access to product documentation
- Easy access to issue/quality control
- Indoor positioning - navigate to the correct position in the 3D model.
- Easy mapping from BIM objects to material procurement.
- Create order lists and obtain QR location data for boxes from suppliers.

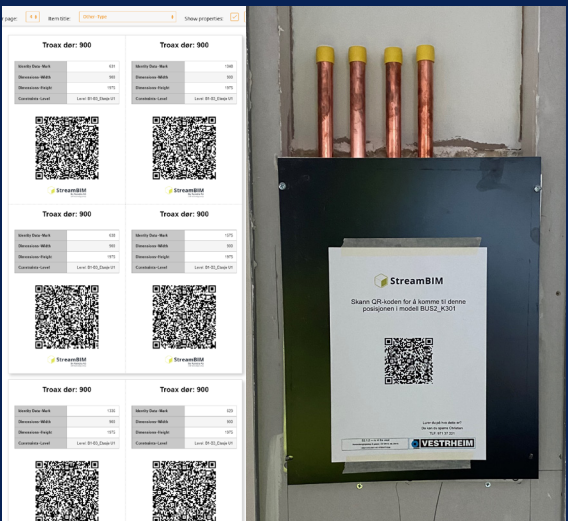

# TAKT Planning

StreamBIM can be used for LEAN inspired, model based production planning and progress monitoring with our new TAKT module.

Make production schedules for work packages (wagons) linked to zones in the BIM and create sequences (trains) that move throughout the project at regular intervals.

Create efficient production schedules, minimize conflicts between teams and monitor your progress in near real time real-time.

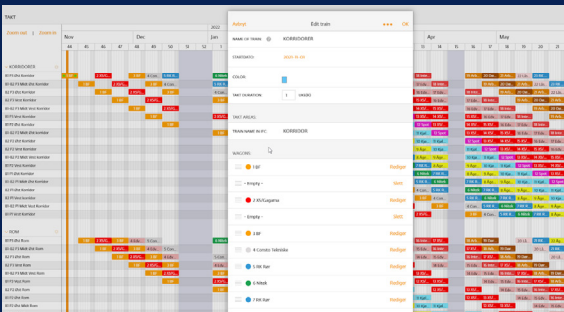

Some of the features:

- Use IFC spaces as tact zones
- Build trains and wagons with checklists
- Seamless handover of production zones
- Visualisation of progress and warning of delays or issues/deviations.
- Overview of the relevant production zones in both 2D and 3D, including their status.

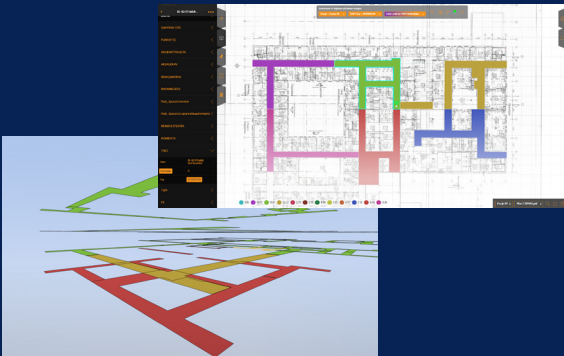

# Get in touch!

If you have any questions about using StreamBIM for your project or would like to book a demonstration, please contact our Tokyo office at:

**E-mail: [japan@streambim.com](mailto:japan@streambim.com)**



**Jostein Edvardsen**  
Japan Country Manager

StreamBIM is easy DX for all levels of expertise. We can help you start your digital journey from scratch, or help you improve your company's current setup and adopt the latest Nordic DX techniques - and give your company a real digital edge.

---

## Get started today!

Start your free 30-day trial on our Japan server

**<https://streambim.com/free-trial-basic-japan/>**

